

4MP 33X Explosion Proof Anti-Corrosion Fixed IR Camera with wiper

Explosion Proof Mark

Ex II 2G Ex db op is IIC T6 Gb
II 2D Ex tb op is IIIC T80° C Db IP68
IP66

Explosion-proof design

the camera has passed international ATEX certifications, and can be used in gas and dust hazardous scenarios

Material

316L stainless steel enclosure and anti-corrosion spray treatment, protecting the camera from damage caused by sparks or corrosive materials

Ingress Protection

IP68/IK08 water resistant and vandal proof, preventing water ingress for outdoor use



Key Features

4MP

Ultra
H.265

WDR

IP68

IK10

Smart Intrusion
Prevention

smart wiper

IRPA

- Resolution :up to 4MP (2560*1440) ,Output Full HD :2560*1440@30fps Live Image.
- Support H.265/H.264/MJPEG Video Compression Algorithm ,Multi-level Video Quality Configuration and Encoding Complexity Settings.
- 1T intelligent computing power, Supports deep algorithm learning to improve the performance of intelligent event algorithms
- Starlight Low Illumination, 0.001Lux/F1.5(color),0.0005Lux/F1.5(B/W) ,0 Lux with IR
- 33X Optical Zoom, 16X Digital Zoom
- Support 3-stream Technology, each stream can be independently configured with resolution and frame rate
- ICR automatic switching, 24 hours day and night monitoring
- Support Backlight Compensation, Automatic Electronic Shutter ,adapt to different monitoring environment
- Support 3D Digital Noise Reduction, High light Suppression, Electronic Image Stabilization, 120dB Optical Wide Dynamic.
- Support 255 Preset,8 patrols ; Support Timed Capture and Event Capture ; Support One-click watch and One-click cruise functions ; Support Micro SD / SDHC / SDXC card storage up to 256G ; ONVIF.
- IR-Cut Removable (ICR) Filter for Day/Night switching High-efficiency infrared/white light array lamp, low thermal energy, low power consumption, infrared distance up to 100m.
- Intelligent wiper function, the wiper adopts automobile wiper blade, which has good weather resistance and easy replacement.

Specification

Camera

Image Sensor	1/2.8" Progressive Scan CMOS
Minimum Illumination	Color:0.001 Lux @(F1.5,AGC ON);B/W:0.0005Lux @(F1.5,AGC ON)
Shutter	1/25s to 1/100,000s; Supports delayed shutter
Autoiris	DC
Day/Night Switch	IR cut filter
Digital Zoom	16X

Lens

Focal Length	5.5-180mm, 33X Optical Zoom
Aperture Range	F1.5-F4.0
Horizontal Field of View	60.5-2.3° (wide-tele)
Minimum Working Distance	100mm-1000mm (wide-tele)
Zoom Speed	Approximately 3.5s(optical lens, wide to tele)

Compression Standard

Video Compression	H.265 / H.264 / MJPEG
H.265 Type	Main Profile
H.264 Type	BaseLine Profile / Main Profile / High Profile
Video Bitrate	32 Kbps~16Mbps
Audio Compression	G.711a/G.711u/G.722.1/G.726/MP2L2/AAC/PCM
Audio Bitrate	64Kbps(G.711)/16Kbps(G.722.1)/16Kbps(G.726)/32-192Kbps(MP2L2)/16-64Kbps(AAC)
Image (Maximum Resolution: 2560*1440)	
Main Stream	50Hz: 25fps (2560*1440, 1920 × 1080, 1280 × 960, 1280 × 720); 60Hz: 30fps (2560*1440, 1920 × 1080, 1280 × 960, 1280 × 720)
Third Stream	50Hz: 25fps (2560*1440); 60Hz: 30fps (2560*1440)
Image Settings	Corridor mode, saturation, brightness, contrast, sharpness adjusted by IE/ Client
BLC	Support
Exposure Mode	AE / Aperture Priority / Shutter Priority / Manual Exposure
Focus Mode	Auto Focus / One Focus / Manual Focus / Semi-Auto Focus
Area Exposure / Focus	Support
Optical Fog	Support
Image Stabilization	Support
Day/Night Switch	Automatic, manual, timing, alarm trigger
3D Noise Reduction	Support
Picture Overlay Switch	Support BMP 24-bit image overlay, customizable area
Region of Interest	ROI supports three streams and four fixed areas

NetWork

Supports BMP 24-bit Image Overlay, Customizable Area	Support Micro SD / SDHC / SDXC card (256G) disconnected local storage, NAS (NFS, SMB / CIFS support)
Protocols	TCP/IP,ICMP,HTTP,HTTPS,FTP,DHCP,DNS,RTP,RTSP,RTCP,NTP,SMTP,SNMP,IPv6
Interface Protocol	ONVIF(PROFILE S,PROFILE G)

Smart Features

Intelligent Computing Power	1T
Smart Detection	Cross-border detection, area intrusion detection, leaving area detection, hovering detection, personnel gathering detection, fast motion detection

Interface

External Interface	36pin FFC (Network port、RS485、RS232、SDHC、Alarm In/Out、Line In/Out、power)
--------------------	--

Specification

General	
Power	DC 12V±25% AC100V -240V optional
Dimensions (L × W × H)	430× 183× 263mm
Net Weight	≤8kg
Material	Stainless Steel 316L
Working Environment	-40°C ~ 60°C , Humidity: ≤100% RH (non-condensing)
Storage Environment	-40°C ~ 60°C , Humidity: ≤100% RH (non-condensing)
Surge Protection	2KV
Ingress Protection	IP68
Infrared Distance	50-100m
Inlet Hole	1 Entry hole G3/4"
Specification	
Installation Method	Wall or column platform installation
Approval	
Protection	IK08 (IEC 62262:2002), IP68 (IEC 60529-2013)
Explosion-Proof Protection	ATEX: II 2G Ex db IIC T6 Gb/ II 2D Ex tb IIIC T80°C Db IP68 IECEx: Ex db IIC T6 Gb /Ex tb IIIC T80°C Db IP68 For explosive gas atmospheres, the maximum surface temperature is 85°C; For flammable dust atmospheres, the maximum surface temperature is 80°C; IIC: for explosive gas atmospheres other than mines susceptible to firedamp; For explosive gas mixture atmospheres: Zone 1, Zone 2, Zone 21, Zone 22.

Application Scenarios



Oil & Gas



Refineries & Fuel Depots



Surveillance & Security



Chemie & Pharma



Oil tankers

Other application areas : desert drill sites , offshore rigs , mechanical engineering ,biogas plants , military, electric power, hydraulic power, railway, metallurgy, natural gas extraction, drilling platform, aerospace, marine, armed police, border defense ,vessels ,fireworks production ,ports etc

Group II (Gas & Dust)	ATEX / IECEx / EAC-Ex				
Zone	0	1	2	21	22
Application	✗	✓	✓	✓	✓

Group I (Mining)	ATEX / IECEx..	
Category	Ma	Mb
Application	✗	✗

DIMENSIONS

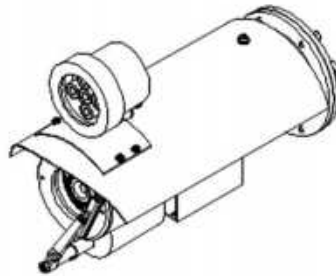
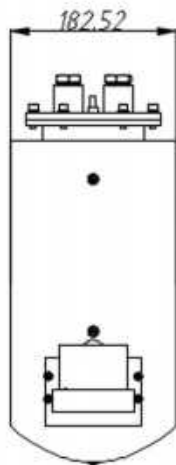
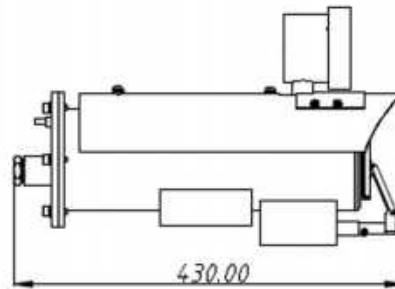
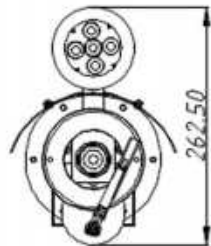
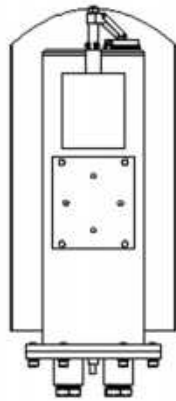

Accessories



Bracket



Ex-Proof Hose



Ex-Proof Junction Box